

Premium Booth A 3mW x 3mD

PP-A-9
3mW x 3mD x 3.5mH

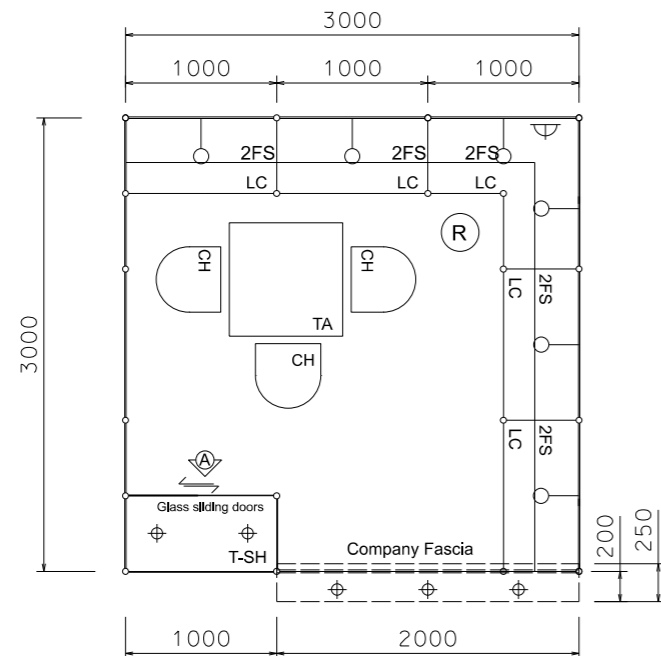

PLAN

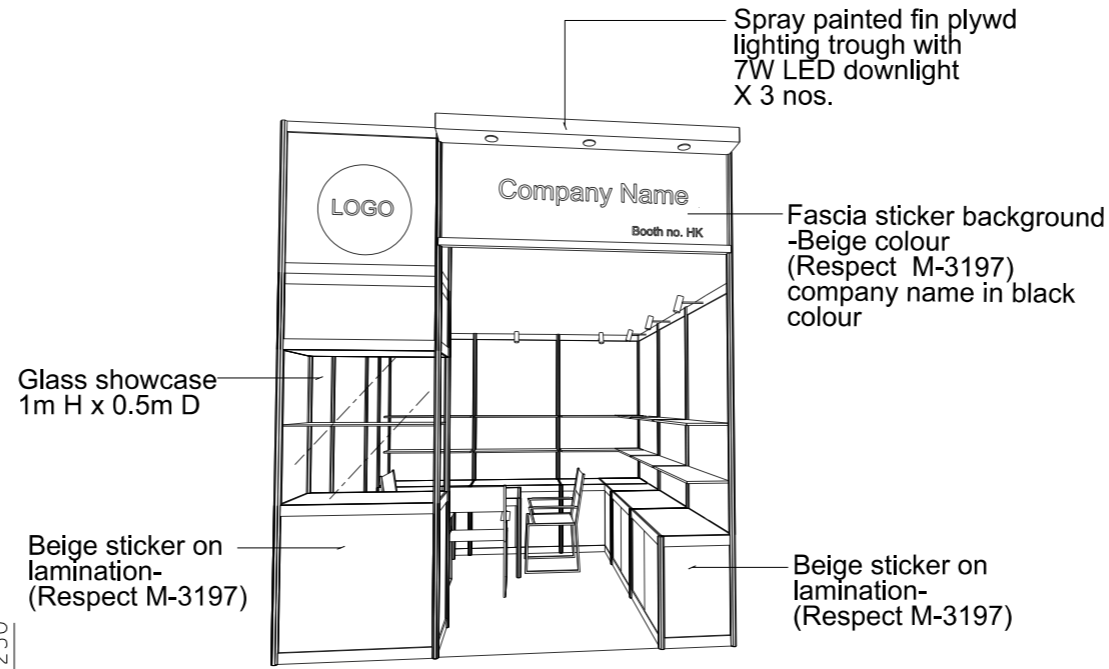

PERSPECTIVE N.T.S.



COLOUR PERSPECTIVE N.T.S.

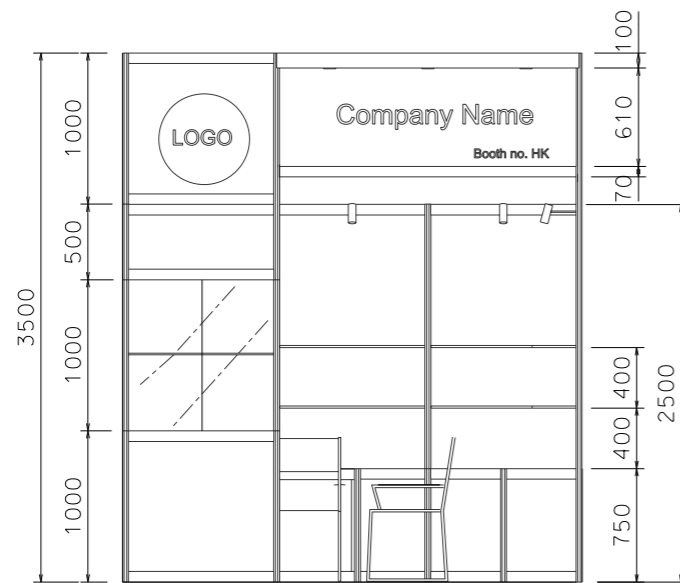

FRONT ELEVATION

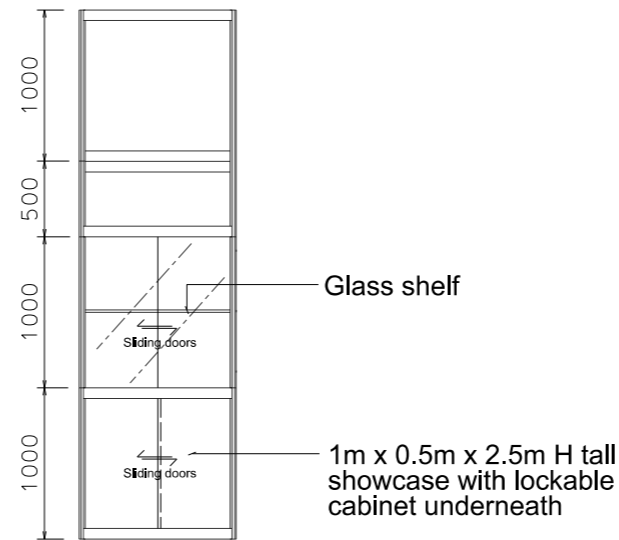

VIEW A

| BOOTH SPECIFICATION | | QTY |
|---------------------|---|-------|
| | Tall showcase in beige sticker lamination, 1 layer of glass shelf, 2x 7W LED downlights | 1 |
| | Lockable cabinet in beige sticker lamination (1mL x 0.5mD x 0.75mH) | 5.5 |
| | Wooden shelf (flat) (1mL x 0.3mD) | 12 |
| | Square meeting table (0.7m X0.7m x 0.75mH) | 1 |
| | Black leather chair | 3 |
| | Longarmed spotlight w/13 watt led lamp (yellow) | 6 |
| | 7W LED downlight (for fascia) | 3 |
| | 500w Square pin power socket | 1 |
| | Company Logo | 1 |
| | Rubbish Bin | 1 |
| | Carpet | 9 SQM |

FILE PATH - I:\o-Booth drawing\0427 Print_packaging\CR INTERNAL USE\Premium\PP-A-Layout.dgn



NOTES UNLESS OTHERWISE SPECIFIED ALL DIMENSIONS ARE IN MM.

.....
.....
.....

REVISION

DATE: 09/12/2021
SCALE: 1 : 50 (A3)
DRAWN BY: JASON
CHECKED BY:

TITLE

Premium Booth A PP-A-9

PROJECT

PREMIUM BOOTH 3m x 3m

DATE: XXXXXXXX

SHEET

PP-A01